

PosterGrip® Frame User Guide

Wall-Mounting Instructions

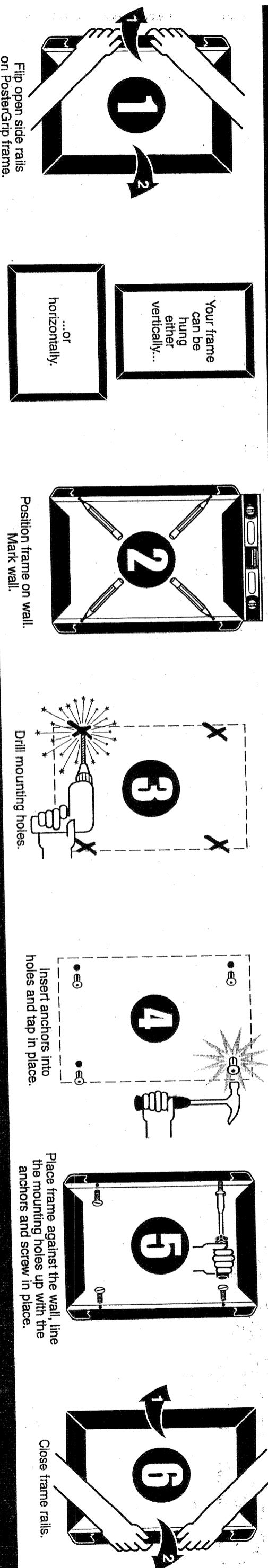

Pole-Mounting Instructions

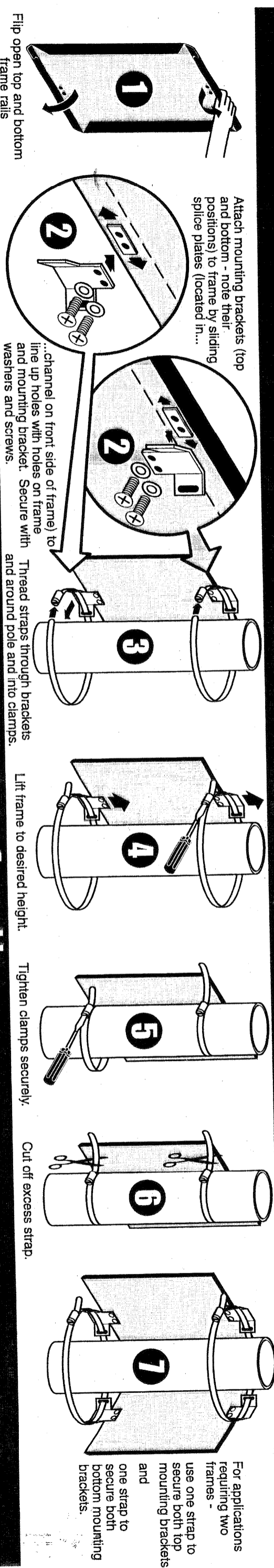

Knock-Down Frame Assembly

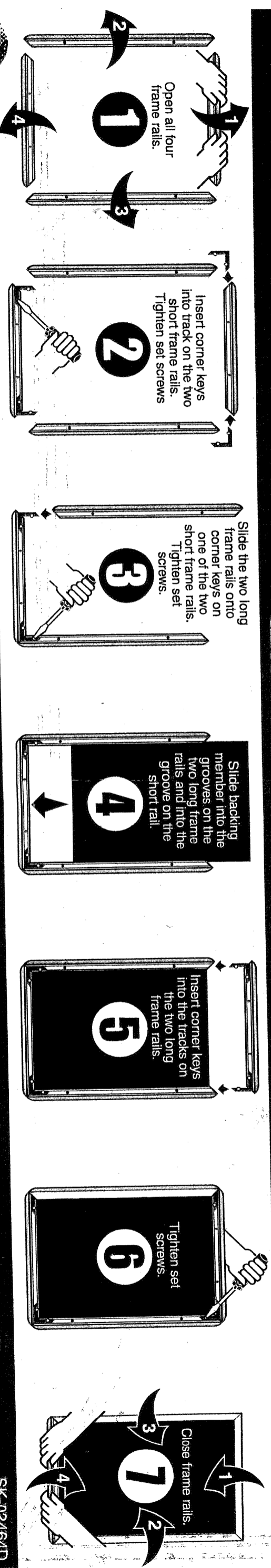

MDI

1-800-228-8925 www.mdiworldwide.com

SK-02464D

PosterGrip® Frame User Guide

PosterGrip® Frame Miter Alignment

1

After receiving your assembled or assembling your knock-down frame, inspect corners for binding or gaps.

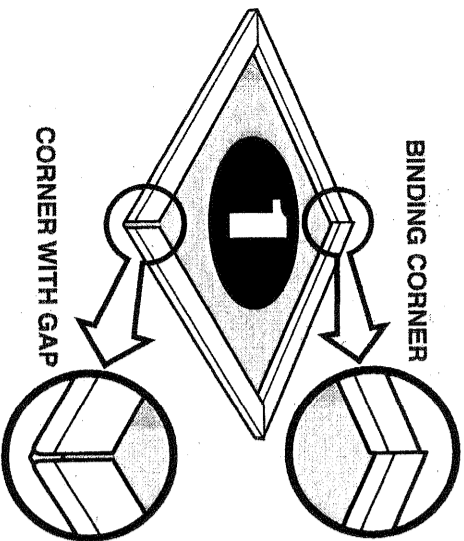

BINDING CORNER

2

If there are gaps or corners that bind, open the 2 adjacent frame rails that need adjustment.

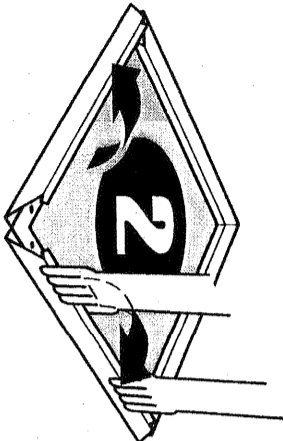

CORNER WITH GAP

3

Apply force in the direction you want the frame rail to move while rocking the rail open and closed quickly.

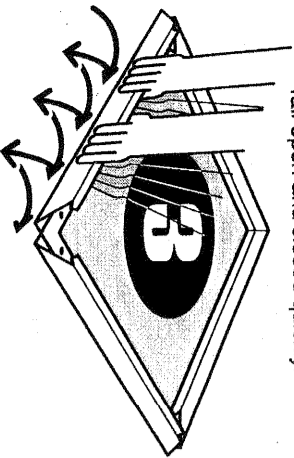

4

Repeat on adjacent rail.

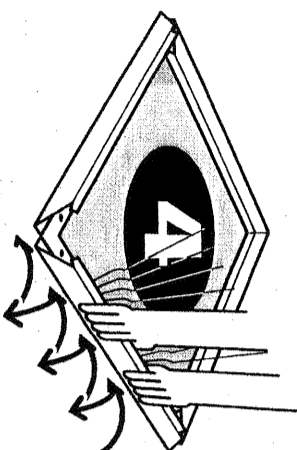

5

Close frame rails and inspect corner. Repeat steps 2,3 and 4 until corners meet without gapping or binding.



6

Repeat same procedure to adjust other corners that may need adjusting.

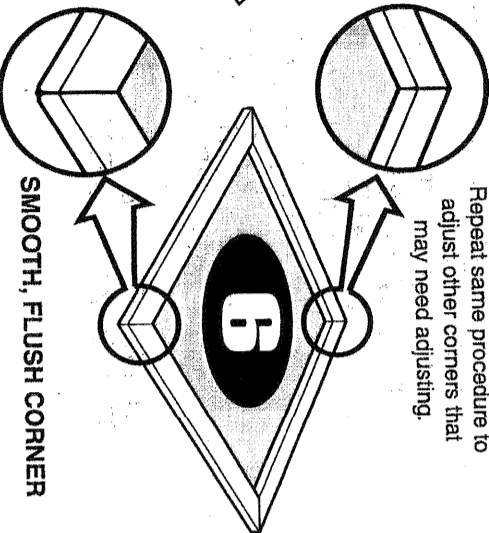

SMOOTH, FLUSH CORNER

Attaching D-Ring Hanging Clips

D-rings are an optional accessory.

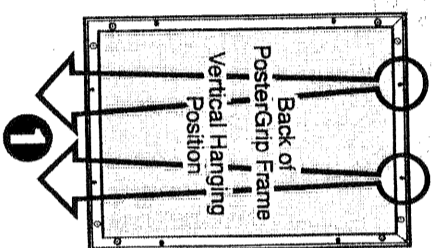

Squeeze D-rings together.

2

Insert into appropriate holes.

3

Release.

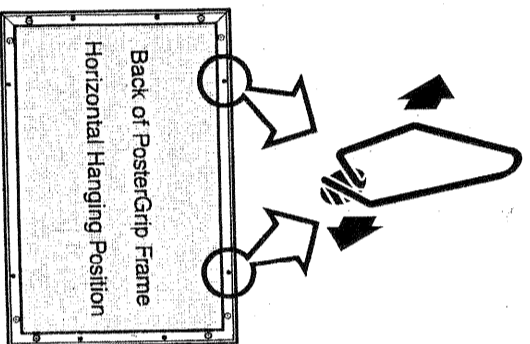

PosterGrip® Frame User Guide

Poster Installation



Open frame by lifting inside edge of all four frame rails.

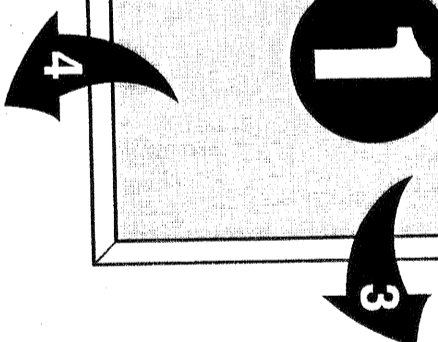

Place poster against back of frame.

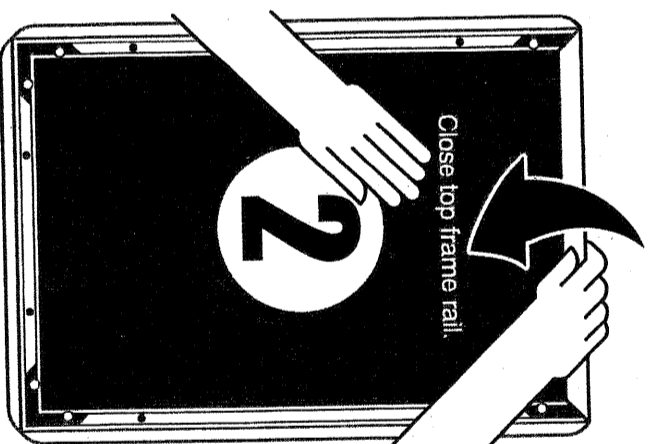

Close top frame rail.

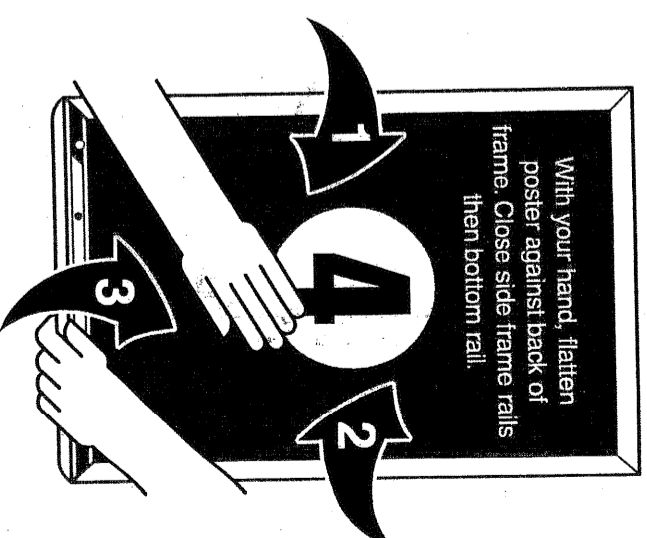

With your hand, flatten poster against back of frame. Close side frame rails then bottom rail.

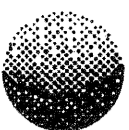

MDI

1-800-228-8925 www.mdiworldwide.com

SK-02464D



MDI

1-800-228-8925 www.mdiworldwide.com

SK-02464D